

## IMPORTANT SAFETY DIRECTIONS

Please carefully read all of the information in this manual before installing or using this product

- Consult a licensed electrician if you are not sure about the installation
- All electrical connections must be in accordance with electrical code in your region
- Indoor use only, do not use in wet locations
- Use only insulated staples or plastic ties to secure power supply cable
- This light set is not suitable for dimmers and electronic switches



**\*\*\* TURN MAIN POWER OFF before starting installation and determine whether to use surface mounting or recessed mounting installation.**

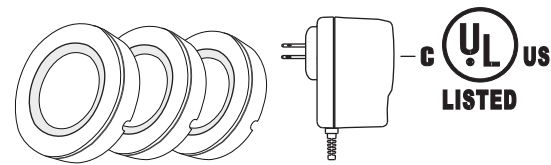
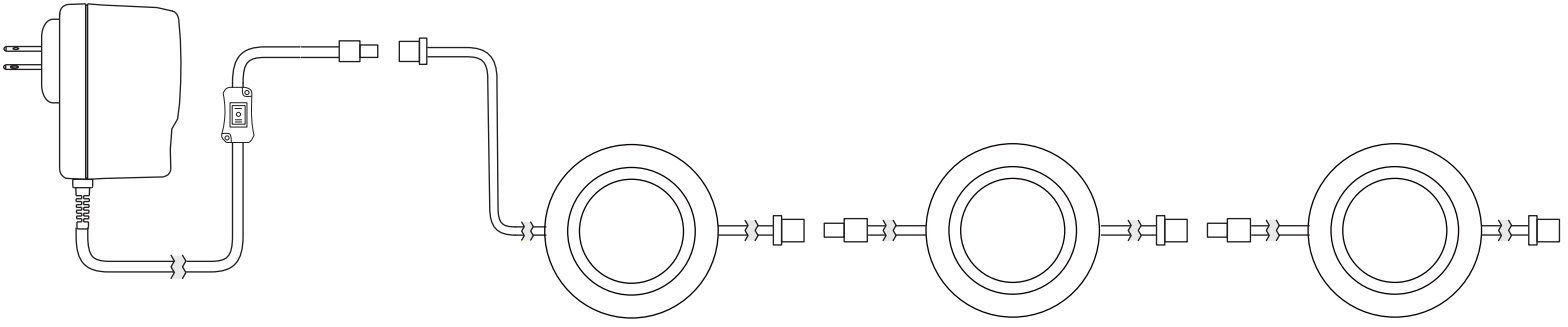

### Specification:

- Material: PC
- LED Qty/Source: 18pcs 3528 SMD
- Luminous Flux: 120Lm/pcs
- Power: DC 12V, 0.5A with UL certificated
- Finish Color: WHITE
- Color Temperature: 3000k
- Beam Angle: 120°
- CRI: >70
- Cable length: 59.1 inches (1.5m)
- Opening Dimension: Φ2.56 inches (65mm)

**Package include:** 6 x screws | 3 x 2 watts LED disc light | 1 x UL-listed power adapter (12V 0.5A)

### Surface Mounting Installation

1. Carefully separates the LED puck light from its surface mounting ring using a flat screw driver.
2. Locate the puck light in desired position and mark the screw holes position. Drill holes accordingly.
3. Install the surface mounting ring using the screws provided.
4. Snap housing into surface ring; be sure to pull excess wire through notch to prevent pinching or bunching of wires.
5. Repeat step 2 to 4 and mount the other lights.

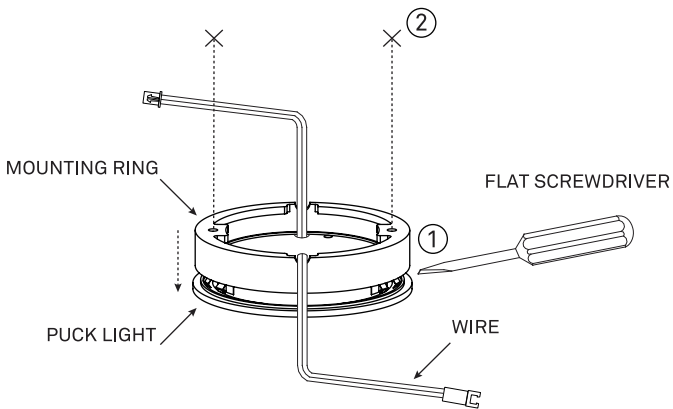

### Recessed Mounting Installation

1. Carefully separates the LED puck light from its surface mounting ring using a flat screw driver.
2. Locate the puck light in desired position and mark the installation location. Make sure to position notch in right direction.
3. Drill a 2.56 inch (65 mm) hole in the mounting surface.
4. Insert puck light through the hole with wires pulled through. The spring clips on the side of puck light will snap to the edge of the hole and hold the light in place.
5. Repeat step 2 to 4 and mount the other lights.

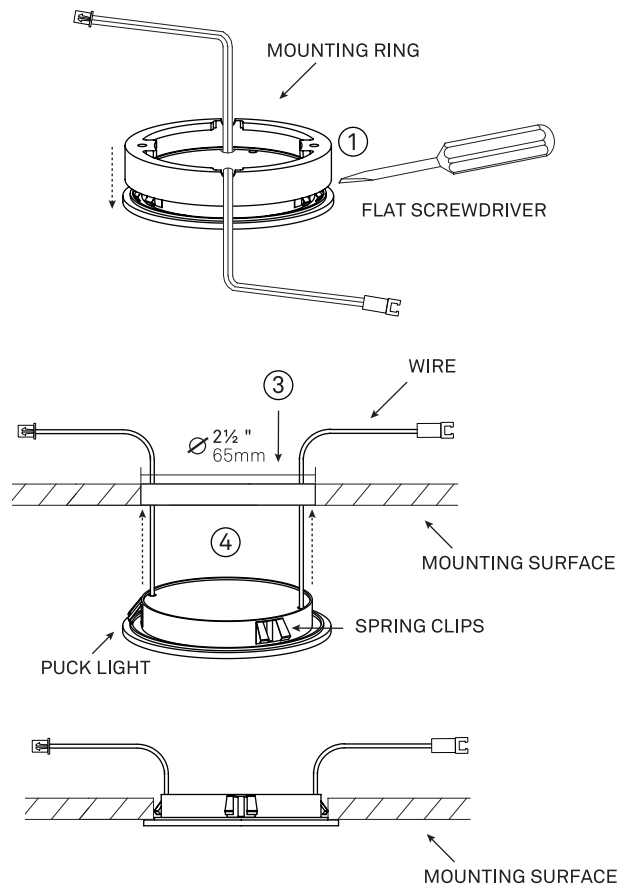

### Connect the Power Supply Cable To Light

Align the plug and the light connector with arrow side of connector.

**Make sure the connectors are in right position: male to female.**

